



PUMP SECTION

Centrifugal Pumps, Type A5

APPLICATION AND FEATURES

Mepco A5 pump is of the volute type for horizontal or vertical installation.

Typical supply system application includes boiler feed, processing, drainage, washer service and booster service. These pumps are also used as circulators in evaporative condensers, cooling towers, hot water and chilled water systems, etc.

Sixteen sizes are available in the A5 with ranges from 1/3 HP to 2 HP and capacities to 150 GPM.

For applications involving fluids other than water (glycols, brines, light oils) consult factory for recommendations.



CONSTRUCTION DETAILS A5

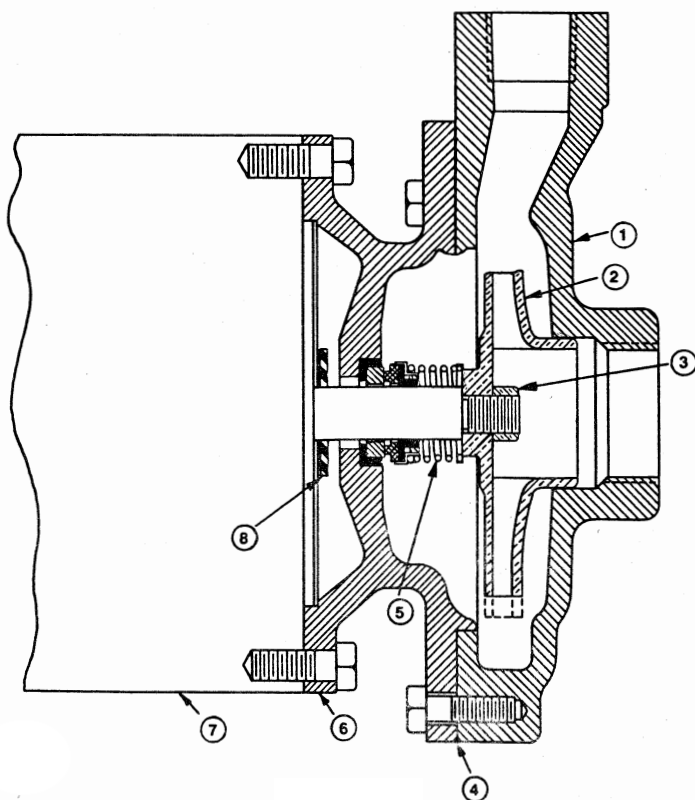

1. **CASE** - Cast iron. Suction and discharge connections tapped for standard pipe. Discharge connection can be located in any of eight angular positions 45° apart. Available in bronze as an option. Pumps are suitable for 175 PSI working pressure.
2. **IMPELLER** - Bronze of enclosed design. Dynamically balanced.
3. **IMPELLER NUT** - Stainless Steel with stop.
4. **CASE GASKET** - High density non-asbestos.
5. **SHAFT SEAL** - Mechanical assembly. Rotary type.
6. **HEAD** - Cast iron. May be furnished bronze as an option.
7. **MOTOR** - Ball-bearing, drip proof frame with conduit box for easy connection. Screwdriver holding slot in shaft end opposite the centrifugal pump on A5 pumps. Shaft and mounting flange comply with NEMA standards permitting interchangeability. Dual voltage 115/230 single phase, 60 cycle with built in thermal overload protection 3/4 HP and below. For three phase, 60 cycle 230/460 or 200 volt is furnished. Sized so maximum brake HP output required is, in each case, less than that allowed by motor manufacturers guaranteed service factor.
8. **SLINGER** - Composition disc type A5.

RAPID SELECTION CHART

TYPE A5 3450 RPM

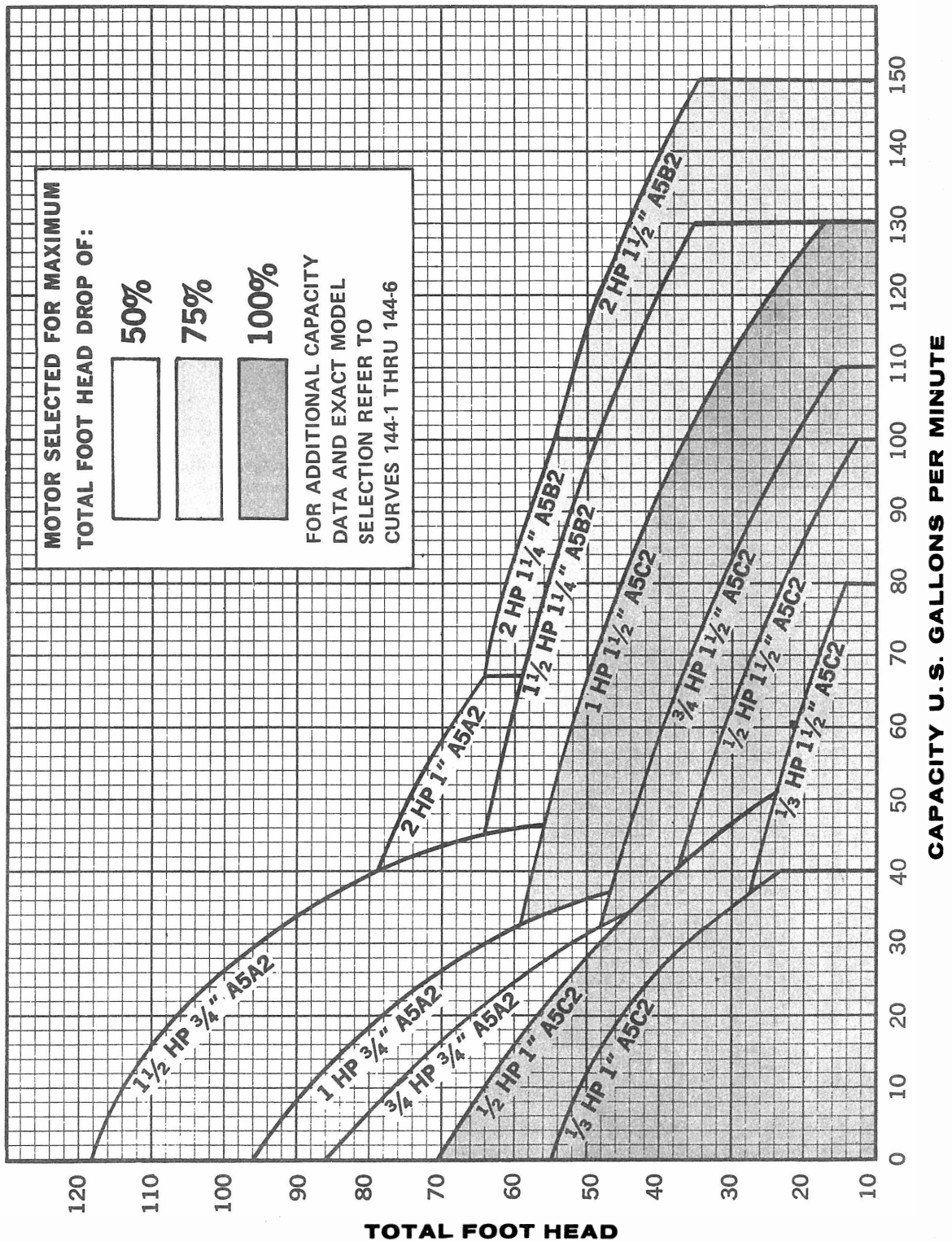

CENTRIFUGAL PUMP DIMENSIONS—TYPE A5

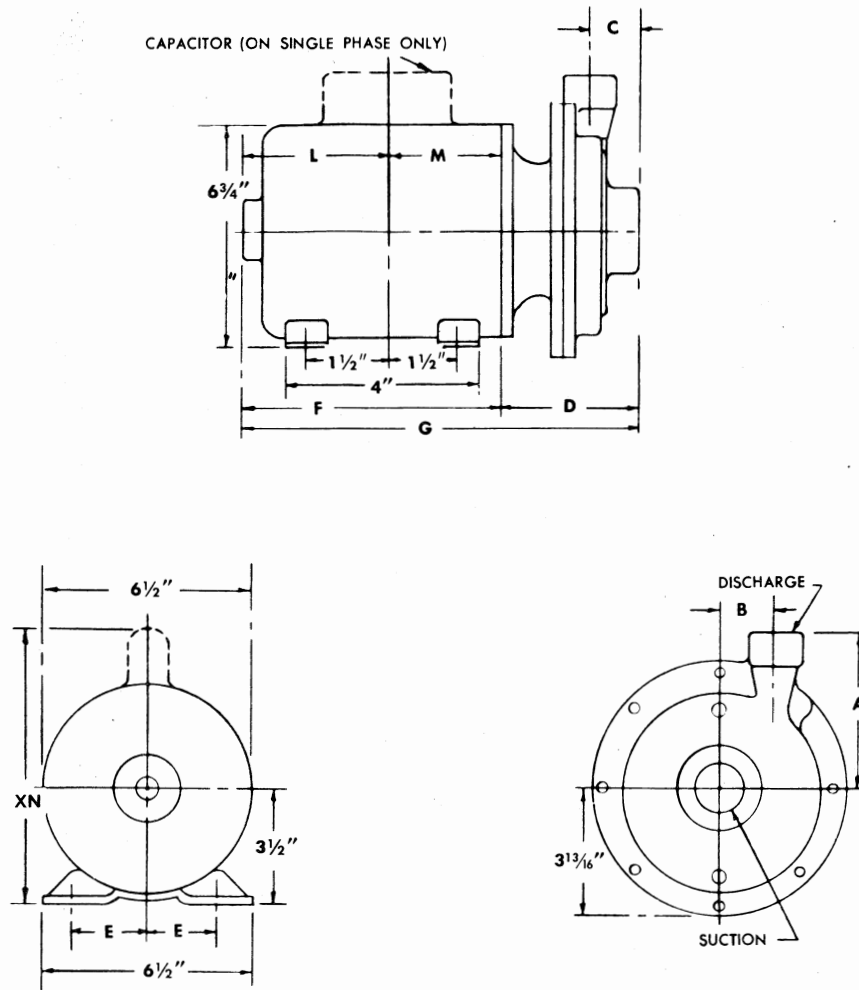

CATALOG NUMBER					DIMENSIONS																	SHIPPING WGT. LBS.
MOTOR	DIS①	TYPE	CODE	MODEL	CENTRIFUGAL PUMP					MOTORS												
										1-60-115/230						3-60-230/460 or 200						
					DIS①	SUC②	A	B	C	D	F	E	L	M	XN	G	F	E	L	M	G	
¼ HP ¾ A5 A 1	¾	1¼	4¾	1¾	1½	4⅞	7¾	2⅞	3⅞	4⅞	8⅞	11⅞	7¾	2⅞	3⅞	4⅞	11⅞	44				
¼ HP 1 A5 A 1	1	1½	5⅞	1¾	1¾	4½	7¾	2⅞	3⅞	4⅞	8⅞	12¼	7¾	2⅞	3⅞	4⅞	12¼	47				
¼ HP 1½ A5 B 1	1½	2	4¾	3¾	1⅞	4⅞	7¾	2⅞	3⅞	4⅞	8⅞	12½	7¾	2⅞	3⅞	4⅞	12½	48				
½ HP 1 A5 C 2	1	1½	5⅞	1¾	1¾	4½	7¾	2⅞	3⅞	4⅞	8⅞	12¼	7¾	2½	3¾	4	12¼	45				
½ HP 1½ A5 C 2	1½	2	4¾	3¾	1⅞	4⅞	7¾	2⅞	3⅞	4⅞	8⅞	12¾	7¾	2½	3¾	4	12¾	47				
½ HP 1 A5 C 2	1	1½	5⅞	1¾	1¾	4½	8	2⅞	3⅞	4⅞	8⅞	12½	8	2½	4	4	12½	48				
½ HP 1½ A5 C 2	1½	2	4¾	3¾	1⅞	4⅞	8	2⅞	3⅞	4⅞	8⅞	12⅞	8	2½	4	4	12⅞	50				
¾ HP ¾ A5 A 2	¾	1¼	4¾	1¾	1½	4⅞	9	2⅞	4⅞	4⅞	9	13⅞	9	2½	5	4	13⅞	52				
¾ HP 1½ A5 C 2	1½	2	4¾	3¾	1⅞	4⅞	9	2⅞	4⅞	4⅞	9	13⅞	9	2½	5	4	13⅞	55				
1 HP ¾ A5 A 2	¾	1¼	4¾	1¾	1½	4⅞	9¾	2⅞	5⅞	4⅞	9	13½	9	2½	5	4	13½	55				
1 HP 1½ A5 C 2	1½	2	4¾	3¾	1⅞	4⅞	9¾	2⅞	5⅞	4⅞	9	14¼	9	2½	5	4	13⅞	58				
1½ HP ¾ A5 A 2	¾	1½	4¾	1¾	1½	4¼	10⅞	2⅞	6⅞	4⅞	9	14¼	9¾	2½	5¾	4	13½	58				
1½ HP 1¼ A5 B 2	1¼	2	4¾	1¾	1⅞	4⅞	10⅞	2⅞	6⅞	4⅞	9	14⅞	9¾	2½	5¾	4	14⅞	60				
2 HP 1 A5 A 2	1	1½	5⅞	1¾	1¾	4½	10⅞	2⅞	6⅞	4⅞	9⅞	14⅞	10⅞	2½	6⅞	4	14⅞	59				
2 HP 1¼ A5 B 2	1¼	2	4¾	3¾	1⅞	4¾	10⅞	2⅞	6⅞	4⅞	9⅞	14¾	10⅞	2½	6⅞	4	14¾	60				
2 HP 1½ A5 B 2	1½	2	4¾	3¾	1⅞	4⅞	10⅞	2⅞	6⅞	4⅞	9⅞	15	10⅞	2½	6⅞	4	15	61				

① Nominal Pipe Size, Discharge Connection Tapping

② Nominal Pipe Size, Suction Connection Tapping



3695 44th Street SE | Grand Rapids, Michigan 49512-3946 | Phone 616.971.3420 | Fax 616.971.3421 | www.mepcollc.com

FORM 1440H

PRINTED IN U.S.A.