



CENTRIFUGAL PUMPS

TYPE RC09 1-1/2", 2", 2-1/2" 3"

NOMENCLATURE

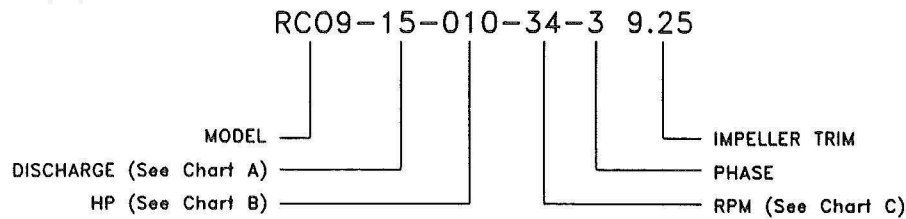

CHART A

15 = 1 1/2"
20 = 2"
25 = 2 1/2"
30 = 3"

CHART C

34 = 3450RPM
28 = 2850RPM
17 = 1750RPM
14 = 1450RPM
11 = 1150RPM

CHART B

010 = 1 HP
015 = 1 1/2 HP
020 = 2 HP
030 = 3 HP
050 = 5 HP
075 = 7 1/2 HP
100 = 10 HP
150 = 15 HP
200 = 20 HP
250 = 25 HP
300 = 30 HP
400 = 40 HP
500 = 50 HP
600 = 60 HP

ORDERING PROCEDURE

Contact your sales rep to order parts. If you do not know who your sales rep is contact the factory for help in locating your sales rep.

When a part number is not known or shown in the parts catalog, the complete model and serial number of the unit on which the part is to be used must be given.

Complete part number and description is required when ordering.

MEPCO reserves the right to substitute parts if they are interchangeable with those ordered.

ITEM	PART #	DESCRIPTION
1	D2-1778	CASING-RC09-15 CAST IRON
1	D2-1801	CASING-RC09-20 CAST IRON
1	D2-1779	CASING-RC09-25 CAST IRON
1	100383	CASING-RC09-30 CAST IRON
1	D2-1795	CASING-RC09-15 BRONZE
1	D2-1802	CASING-RC09-20 BRONZE
1	D2-1796	CASING-RC09-25 BRONZE
1	100384	CASING-RC09-30 BRONZE
2	D2-1789	ADAPTER-G9V/R-9 143-184 CAST IRON
2	D2-1790	ADAPTER-G9V/R-9 213-215 CAST IRON
2	D2-1791	ADAPTER-G9V/R-9 254-256 CAST IRON
2	D2-1792	ADAPTER-G9V/R-9 284-326 CAST IRON
2	100385	ADAPTER-R-9-30 254-256 CAST IRON
2	100386	ADAPTER-R-9-30 284-326 CAST IRON
2	D2-1797	ADAPTER-G9V/R-9 143-184 BRONZE
2	D2-1798	ADAPTER-G9V/R-9 213-215 BRONZE
2	D2-1799	ADAPTER-G9V/R-9 254-256 BRONZE
2	D2-1800	ADAPTER-G9V/R-9 284-326 BRONZE
2	100387	ADAPTER-R-9-30 254-256 BRONZE
2	100388	ADAPTER-R-9-30 284-326 BRONZE

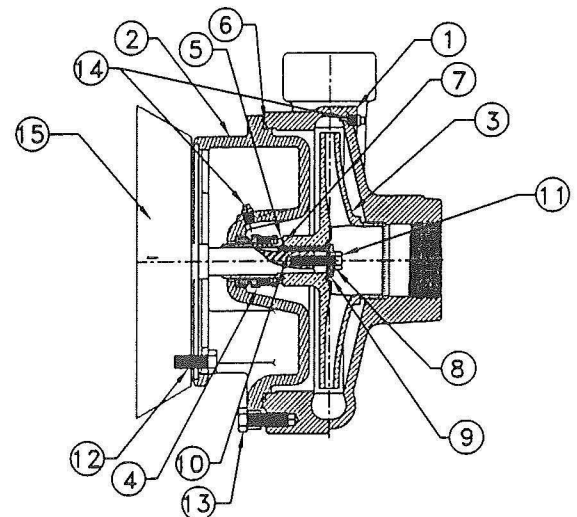

ITEM	PART #	DESCRIPTION
3	C2-4493	IMPELLER-RC09-15 143-215 BRONZE
3	C2-4494	IMPELLER-RC09-15 254-326 BRONZE
3	C2-4514	IMPELLER-RC09-20 143-215 BRONZE
3	C2-4515	IMPELLER-RC09-20 256-326 BRONZE
3	C2-4495	IMPELLER-RC09-25 143-215 BRONZE
3	C2-4496	IMPELLER-RC09-25 254-326 BRONZE
3	100377	IMPELLER-RC09H-30 143-215 BRONZE
3	100536	IMPELLER-RC09H-30 143-215 BRONZE
3	C2-4505	IMPELLER-RC09-15 143-215 BRONZE
3	C2-4506	IMPELLER-RC09-15 254-326 BRONZE
3	C2-4516	IMPELLER-RC09-20 143-215 BRONZE
3	C2-4517	IMPELLER-RC09-20 256-326 BRONZE
3	C2-4507	IMPELLER-RC09-25 143-215 BRONZE
3	C2-4508	IMPELLER-RC09-25 254-326 BRONZE
3	100380	IMPELLER-RC09H-30 143-215 BRONZE
3	100538	IMPELLER-RC09H-30 143-215 BRONZE
4		SEAL KIT SEE CHART
5	A2-8908	SLEEVE 143-215 (Integral Part of Seal kit)
5	A2-8909	SLEEVE 254-326 (Integral Part of Seal kit)
6	S-4891	O-RING-CASING RC09 (Integral Part of Seal kit)
7	S-4861	O-RING-IMPELLER 143-215 (Integral Part of Seal kit)
7	S-4892	O-RING-IMPELLER 254-326 (Integral Part of Seal kit)
8	S-3313	WASHER-SEALING 143-215 (Integral Part of Seal kit)
8	S-3293	WASHER-SEALING 254-326 (Integral Part of Seal kit)
9	A2-3021XIT.1	WASHER-IMPELLER 143-215 (Integral Part of Seal kit)
9	A2-3021XIT.4	WASHER-IMPELLER 254-326 (Integral Part of Seal kit)
10	A2-8910	KEY-IMPELLER 143-215 (Integral Part of Seal kit)
10	A2-8911	KEY-IMPELLER 254-326 (Integral Part of Seal kit)
11	S-5109	SCREW-CAP IMPELLER 143-215 BF/AB (Integral Part of Seal kit)
11	102D05A9	SCREW-CAP IMPELLER 143-215 IR (Integral Part of Seal kit)
11	S-5203	SCREW-CAP IMPELLER 254-326 BF/AB (Integral Part of Seal kit)
11	102D09B2	SCREW-CAP IMPELLER 254-326 IR (Integral Part of Seal kit)
12	102S06A2	SCREW-WH SER 3/8-16X1 (143-184)
12	102S07A1	SCREW-WH SER 1/2-13X1 (213-256)
12	102S08A2	SCREW-WH SER 5/8-11X1-1/4 (284-326)
13	102S07A4	SCREW-WH SER 1/2-13X1-1/4
14	S-4328	PLUG-PIPE 1/8" SQ HD STEEL
14	101S01A1	PLUG-PIPE 1/8" BRASS
		MOTORS (1750 RPM)
15	S-3142	MOTOR 1 HP 1 PH-ODP-143JM
15	S-3143	MOTOR 1 1/2 HP 1 PH-ODP-145JM
15	S-3144	MOTOR 2 HP 1 PH-ODP-182JM
15	S-5054	MOTOR 3 HP 1 PH-ODP-184JM
15	S-3149	MOTOR 1 HP 3 PH-ODP-143JM
15	S-3150	MOTOR 1 1/2 HP 3 PH-ODP-145JM
15	S-3151	MOTOR 2 HP 3 PH-ODP-145JM
15	S-3152	MOTOR 3 HP 3 PH-ODP-182JM
15	S-3153	MOTOR 5 HP 3 PH-ODP-184JM
15	S-3154	MOTOR 7 1/2 HP 3 PH-ODP-213JM
15	S-3155	MOTOR 10 HP 3 PH-ODP-213JM
15	S-4985	MOTOR 15 HP 3 PH-ODP-254JM
15	S-3142E	MOTOR 1 HP 1 PH-TEFC-143JM
15	S-3143E	MOTOR 1 1/2 HP 1 PH-TEFC-145JM
15	S-3144E	MOTOR 2 HP 1 PH-TEFC-182JM
15	S-3149E	MOTOR 1 HP 3 PH-TEFC-143JM
15	S-3150E	MOTOR 1 1/2 HP 3 PH-TEFC-145JM
15	S-3151E	MOTOR 2 HP 3 PH-TEFC-145JM
15	S-3152E	MOTOR 3 HP 3 PH-TEFC-182JM
15	S-3153E	MOTOR 5 HP 3 PH-TEFC-184JM
15	S-3154E	MOTOR 7 1/2 HP 3 PH-TEFC-213JM
15	S-3155E	MOTOR 10 HP 3 PH-TEFC-215JM
15	S-4985E	MOTOR 15 HP 3 PH-TEFC-254JM

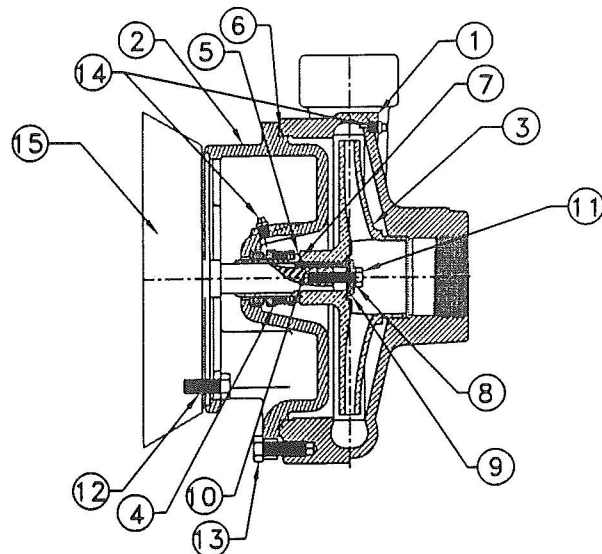

ITEM	PART #	DESCRIPTION
MOTORS (3450 RPM)		
15	S-3181	MOTOR 1 1/2 HP 3 PH-ODP-143JM
15	S-3182	MOTOR 2 HP 3 PH-ODP-143JM
15	S-3183	MOTOR 3 HP 3 PH-ODP-145JM
15	S-3184	MOTOR 5 HP 3 PH-ODP-182JM
15	S-3185	MOTOR 7 1/2 HP 3 PH-ODP-184JM
15	S-3186	MOTOR 10 HP 3 PH-ODP-213JM
15	S-3187	MOTOR 15 HP 3 PH-ODP-215JM
15	S-3188	MOTOR 20 HP 3 PH-ODP-254JM
15	S-3189	MOTOR 25 HP 3 PH-ODP-256JM
15	S-4958	MOTOR 30 HP 3 PH-ODP-284JM
15	S-3189	MOTOR 40 HP 3 PH-ODP-286JM
15	S-4960	MOTOR 50 HP 3 PH-ODP-324JM
15	S-4990	MOTOR 60 HP 3 PH-ODP-326JM
15	S-3181E	MOTOR 1 1/2 HP 3 PH-TEFC-143JM
15	S-3182E	MOTOR 2 HP 3 PH-TEFC-145JM
15	S-3183E	MOTOR 3 HP 3 PH-TEFC-182JM
15	S-3184E	MOTOR 5 HP 3 PH-TEFC-182JM
15	S-3185E	MOTOR 7 1/2 HP 3 PH-TEFC-184JM
15	S-3186E	MOTOR 10 HP 3 PH-TEFC-213JM
15	S-3187E	MOTOR 15 HP 3 PH-TEFC-215JM
15	S-3188E	MOTOR 20 HP 3 PH-TEFC-254JM
15	S-3189E	MOTOR 25 HP 3 PH-TEFC-284JM
15	S-4958E	MOTOR 30 HP 3 PH-TEFC-286JM
15	S-4959E	MOTOR 40 HP 3 PH-TEFC-324JM

SEAL KITS

MOTOR FRAME	SEAL MATERIAL	PUMP TYPE	PART NUMBER
143/215	BUNA N	BF/AB	ML11775
143/215	EPT	BF/AB	ML11776
143/215	VITON	BF/AB	ML11777
143/215	BUNA N	AI	ML11781
143/215	EPT	AI	ML11782
143/215	VITON	AI	ML11783
254/326	BUNA N	BF/AB	ML11784
254/326	EPT	BF/AB	ML11785
254/326	VITON	BF/AB	ML11786
254/326	BUNA N	AI	ML11790
254/326	EPT	AI	ML11791
254/326	VITON	AI	ML11792

SEAL KIT INCLUDES: SEAL, SLEEVE, CASING O-RING, IMPELLER O-RING, SEALING WASHER, IMPELLER WASHER & CAP SCREW.

BF = BRONZE FITTED
AB = ALL BRONZE
AI = ALL IRON

MARSHALL ENGINEERED PRODUCTS CO.

369544th Street SE Grand Rapids, MI 49512

(P) 616-971-3420 (F) 616-971-3421

www.mepcolle.com