



CENTRIFUGAL PUMPS

TYPE RC06 - 1-1/2", 2" and 2-1/2"

REPAIR PARTS

NOMENCLATURE **RC06-15-010-34-3**

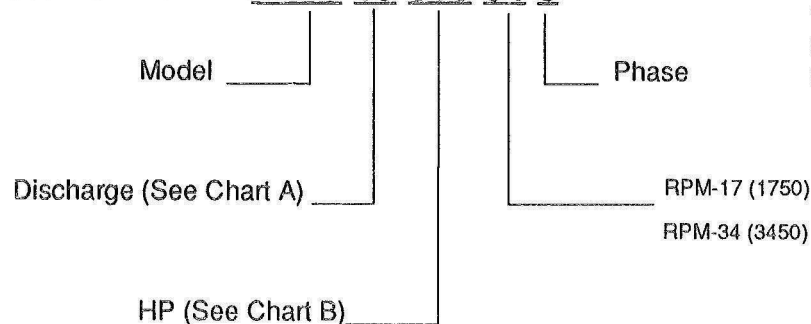

CHART A

15 = 1-1/2"
20 = 2"
25 = 2-1/2"

CHART B

010 = 1HP
015 = 1-1/2HP
020 = 2HP
030 = 3HP
050 = 5HP
075 = 7-1/2HP
100 = 10HP
150 = 15HP
200 = 20HP
250 = 25HP

ORDERING PROCEDURE

Contact your sales rep to order parts. If you do not know who your sales rep is contact factory for help in locating your sales rep.

When a part number is not known or shown in the parts catalog, the complete model and serial number of the unit on which the part is to be used must be given.

Complete part number and description is required when ordering.

MEPCO reserves the right to substitute parts if they are interchangeable with those ordered.

PART ITEM NUMBER	DESCRIPTION
1 D2-1765	CASE-RC06-1-1/2 CAST IRON
1 D2-1766	CASE-RC06-2 CAST IRON
1 D2-1780	CASE-RC06-2-1/2 CAST IRON
1 D2-1781	CASE-RC06-1-1/2 BRONZE
1 D2-1782	CASE-RC06-2 BRONZE
1 D2-1794	CASE-RC06-2-1/2 BRONZE
2 C2-4437	ADAPTER-RC06 143-184JM CI
2 D2-1767	ADAPTER-RC06 213-215JM CI
2 D2-1787	ADAPTER-RC06 254-256JM CI
2 C2-4473	ADAPTER-RC06 143-184JM BRONZE
2 D2-1785	ADAPTER-RC06 213-215JM BRONZE
2 D2-1786	ADAPTER-RC06 254-256JM BRONZE

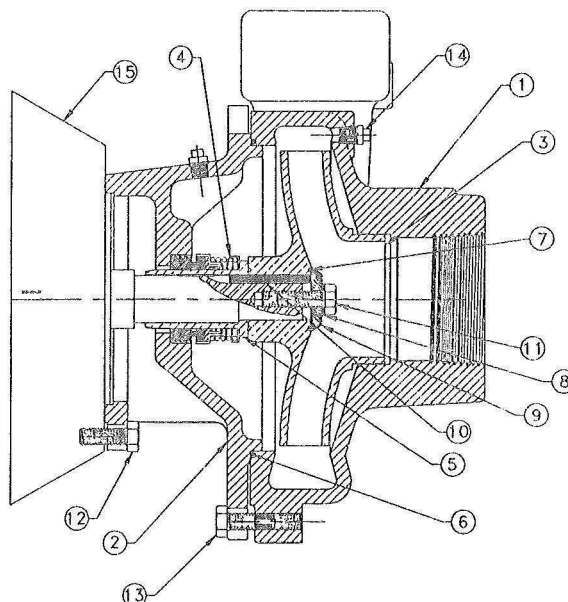

ITEM	PART #	DESCRIPTION
3	C2-4438	IMPELLER RC06-1-1/2 BRONZE
3	C2-4456	IMPELLER RC06-2 BRONZE
3	C2-4479	IMPELLER-RC06-2-1/2 143-215JM BRONZE
3	C2-4480	IMPELLER-RC06-2-1/2 254-256JM BRONZE
3	C2-4486	IMPELLER-RC06-1-1/2 CAST IRON
3	C2-4487	IMPELLER-RC06-2 CAST IRON
3	C2-4488	IMPELLER-RC06-2-1/2 143-215 CI
3	C2-4489	IMPELLER-RC06-2-1/2 254-256JM CI
4		SEAL KIT SEE CHART
5		SLEEVE (Intergal Part of Seal kit)
6		O-RING-CASE (Intergal Part of Seal kit)
7		O-RING-IMPELLER (Intergal Part of Seal kit)
8		WASHER-SEALING (Intergal Part of Seal kit)
9		WASHER-IMPELLER (Intergal Part of Seal kit)
10		KEY-IMPELLER (Intergal Part of Seal kit)
11		SCREW-CAP (Intergal Part of Seal kit)

ITEM	PART NUMBER	DESCRIPTION
12	102S06A1	SCREW-CAP STEEL 143-184JM
12	102S07A4	SCREW-CAP STEEL 213-256JM
13	102S06A3	SCREW-CAP STEEL
14	S-4328	PLUG-STEEL
14	101S01A1	PLUG-BRASS

MOTORS (1750 RPM)

15	S-3142	MTR-1HP 1PH-ODP-143JM
15	S-3143	MTR-1-1/2HP 1PH-ODP-145JM
15	S-3144	MTR-2HP 1PH-ODP-182JM
15	S-3149	MTR-1HP 3PH-ODP-143JM
15	S-3150	MTR-1-1/2HP 3PH-ODP-145JM
15	S-3151	MTR-2HP 3PH-ODP-145JM
15	S-3142E	MTR-1HP 1PH-TEFC-143JM
15	S-3143E	MTR-1-1/2HP 1PH-TEFC-145JM
15	S-3144E	MTR-2HP 1PH-TEFC-182JM
15	S-3149E	MTR-1HP 3PH-TEFC-143JM
15	S-3150E	MTR-1-1/2HP 3PH-TEFC-145JM
15	S-3151E	MTR-2HP 3PH-TEFC-145JM

MOTORS (3450 RPM)

15	S-3183	MTR-3HP 3PH-ODP-145JM
15	S-3184	MTR-5HP 3PH-ODP-182JM
15	S-3185	MTR-7-1/2HP 3PH-ODP-184JM
15	S-3186	MTR-10HP 3PH-ODP-213JM
15	S-3187	MTR-15HP 3PH-ODP-215JM
15	S-3188	MTR-20HP 3PH-ODP-254JM
15	S-3183E	MTR-3HP 3PH-TEFC-182JM
15	S-3184E	MTR-5HP 3PH-TEFC-182JM
15	S-3185E	MTR-7-1/2HP 3PH-TEFC-184JM
15	S-3186E	MTR-10HP 3PH-TEFC-213JM
15	S-3187E	MTR-15HP 3PH-TEFC-215JM
15	S-3188E	MTR-20HP 3PH-TEFC-254JM

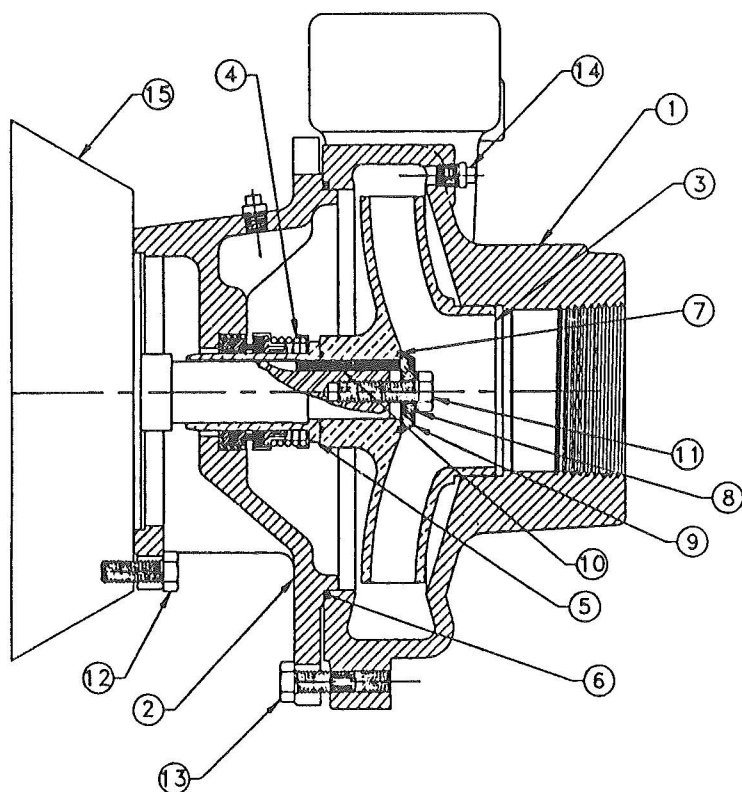

SEAL KITS FOR RC06

MOTOR FRAME	SEAL MATERIAL	PUMP TYPE	PART NUMBER
143/215	BUNA N	BF	ML11775
143/215	EPT	BF	ML11776
143/215	VITON	BF	ML11777
143/215	BUNA N	AB	ML11778
143/215	EPT	AB	ML11779
143/215	VITON	AB	ML11780
143/215	BUNA N	AI	ML11781
143/215	EPT	AI	ML11782
143/215	VITON	AI	ML11783
254/326	BUNA N	BF	ML11784
254/326	EPT	BF	ML11785
254/326	VITON	BF	ML11786
254/326	BUNA N	AB	ML11787
254/326	EPT	AB	ML11788
254/326	VITON	AB	ML11789
254/326	BUNA N	AI	ML11790
254/326	EPT	AI	ML11791
254/326	VITON	AI	ML11792

SEAL KIT INCLUDES; SEAL, SLEEVE, CASE O-RING, IMPELLER O-RING, SEALING WASHER, IMPELLER WASHER & CAP SCREW

NOTE: BF = BRONZE FITTED, AB = ALL BRONZE, AI = ALL IRON

MARSHALL ENGINEERED PRODUCTS CO.

3695 44th Street Grand Rapids, MI 49512

(P)616-971-3420 (F) 616-9791-3421

www.mepcollc.com

Formerly Dunham Division of Dunham-Bush, Inc.